

Self-aligning ball bearings with extended inner ring
d 20 – 60 mm

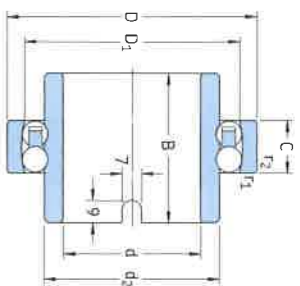

Principal dimensions	Basic load ratings			Fatigue load limit P_u	Limiting speed	Mass	Designation	
	d	D	C					dynamic
20	47	14	12.7	3.4	0.18	9 000	0.18	11204 ETN9
25	52	15	14.3	4	0.21	8 000	0.22	11205 ETN9
30	62	16	15.6	4.65	0.24	6 700	0.35	11206 TN9
35	72	17	15.9	5.1	0.27	5 600	0.54	11207 TN9
40	80	18	19	6.55	0.34	5 000	0.72	11208 TN9
45	85	19	21.6	7.35	0.38	4 500	0.77	11209 TN9
50	90	20	22.9	8.15	0.42	4 300	0.85	11210 TN9
60	110	22	30.2	11.6	0.60	3 400	1.15	11212 TN9

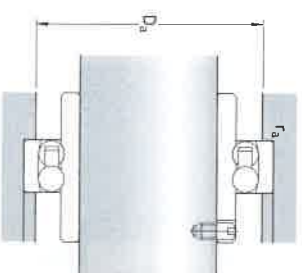

Dimensions	Abutment and fillet dimensions				Calculation factors						
	d	d ₂	D ₁	B	$r_{1,2}$ min	D _a max	r_a max	e	Y ₁	Y ₂	Y ₀
20	28.9	4.1	4.0	1	1	41.4	1	0.30	2.1	3.3	2.2
25	33.3	4.5	4.4	1	1	46.4	1	0.28	2.2	3.5	2.5
30	40.1	5.3	4.8	1	1	56.4	1	0.25	2.5	3.9	2.5
35	47.7	6.0	5.2	1.1	1.1	65	1	0.23	2.7	4.2	2.8
40	54	6.8	5.6	1.1	1.1	73	1	0.22	2.9	4.5	2.8
45	57.7	7.3	5.8	1.1	1.1	78	1	0.21	3	4.6	3.2
50	62.7	7.8	5.8	1.1	1.1	83	1	0.21	3	4.6	3.2
60	78	9.7	6.2	1.5	1.5	101	1.5	0.19	3.3	5.1	3.6